

**Gateway Mews, Shacklewell Lane,
 Dalston
 2 Bedroom Flat**

**Price: Offers in Excess of
 £435,000**



- ✓ 640 Sq Ft - 59.46 Sq M
- ✓ Two Bedrooms
- ✓ Private Garden
- ✓ Chain Free

- ✓ Gated Mews Developmet
- ✓ Two Bathrooms
- ✓ 2 X Private Patios

Gateway Mews, Shacklewell Lane, Dalston

A newly refurbished two bedroom apartment on the ground floor of a private gated mews. This contemporary flat offers a large double bedroom with en suite bathroom and private patio, a single bedroom with private patio, a modern tiled main bathroom, a spacious bright reception room with private garden and separate modern fitted kitchen. (640 Sq Ft - 59.46 Sq M). Chain Free.

Ideally situated in an attractive, quiet gated mews with access to shared reserved off street parking.

Dalston Kingsland and Dalston Junction stations are both within close proximity as are the eclectic offerings of the ever-popular Kingsland Highstreet with a plethora of bars and restaurants.



Particulars are thought to be materially correct though their accuracy is not guaranteed and they do not form part of any contract. Services, fittings and equipment referred to within the sales particulars have not been tested and no warranties can be given and prospective buyers must make their own enquiries regarding such matters.

Measurements are approximate and are for a guide only (room measurements are taken and to be to the nearest 3"), we would therefore advise prospective purchasers to check any measurements that are of particular importance to them. Some statements are inevitably 'subjective' and are therefore the view of the author at the time the information was prepared. If any items are important to you, please check with the office first, especially if you are travelling some distance to view.

GATEWAY MEWS

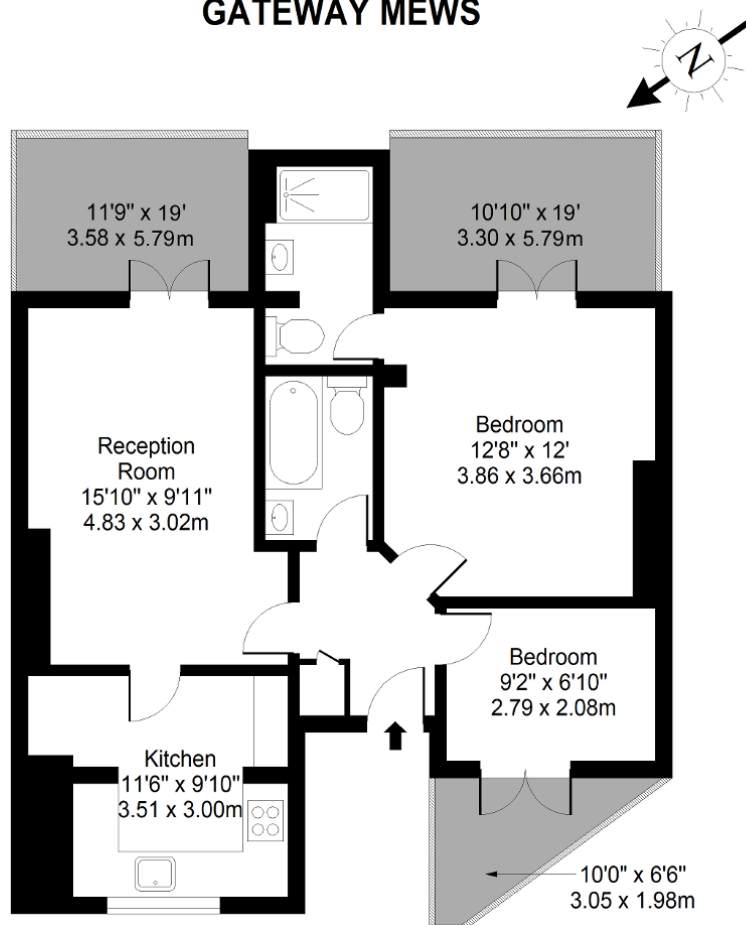

Ground Floor

Approx. Gross Internal Area 640 Sq Ft - 59.46 Sq M
 For Illustrative Purposes Only - Not To Scale

Energy Performance Rating

